

7 Series 757 · 767



For professional usage



Cold water



Standard Equipment

AR334 (BIT105)

Gun 1/4"(M)/M22x1,5
(40925)



Lance + w/head

757 (40030)
767 (40112)



HP hose 10m

757 (1271350)
767 SAE100 RI Reinforced (1271960)



RLW



RLW Version

Specifications

| Model | Code | Technical Data | | | | | | | Logistical Data | | | | | | |
|------------------------------------|--------------|----------------|------|-----------|-----|------------------|------|------|------------------|------------|-----------------|-------|-----------|-------|--------|
| | | Max Pressure | | Flow Rate | | Power (absorbed) | | | Outer Dimensions | Packaging | Quantity pallet | | container | truck | Weight |
| | | bar | psi | lt/h | gph | kw | rpm | Hz | V | LxWxH (cm) | LxWxH (cm) | 20 ft | 40 ft | | kg |
| 757 | 12363 | 130 | 1900 | 500 | 132 | 2,2 | 2800 | 1~50 | 230 | | | | | | 33 |
| 767 | 12364 | 130 | 1900 | 600 | 159 | 2,6 | 1450 | 1~50 | 230 | | | | | | 34 |
| 757 RLW | 12408 | 130 | 1900 | 500 | 132 | 2,2 | 2800 | 1~50 | 230 | 39x38x90 | 80x40x58 | 9 | 99 | 225 | 297 |
| 767 RLW | 12409 | 130 | 1900 | 600 | 159 | 2,6 | 1450 | 1~50 | 230 | | | | | | 35 |
| Max inlet water temperature | | 60°C 140°F | | IPX5-S1 | | | | | | | | | | | |

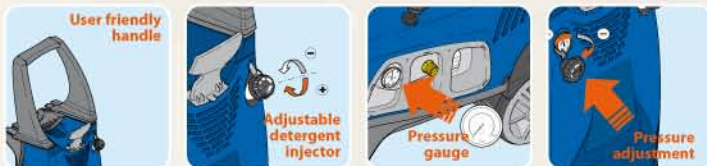

TSS®
Total Stop
SYSTEM

Equipped with

- › A two wheels trolley mounted unit with detergent tank and handle
- › Triplex pump with ceramic plungers, connecting rod system
- › Brass pump head (767 mod.)
- › Automatic by-pass valve
- › Pressure adjustment
- › Pressure gauge
- › Built-in detergent suction w/ adjustment
- › Motor thermal protector
- › Power supply cord length 5m
- › TSS, remote control for total shut-down of high pressure cleaner, (767 mod.)
- › Water filter
- › Detergent tank capacity 2l
- › H.P. soft type hose gun and lance
- › Adjustable high/low pressure and fan/pencil jet spray



Mod. 757
(HPV)



Mod. 767
(HPE)

Optional Accessories

Scrubber Brush

Stubborn dirt removing brush kit (40511)



X-Wash Brush Pro

Wash brush kit (40605)



X-Roller Brush Pro

Roller brush kit (40606)



X-Roller Brush Chem Pro

Roller brush chem kit (40607)



X-Roller Brush Flex Head Pro

Roller Brush Flexible Head Pro kit (40608)



Twister M22x1,5

Large surface cleaner kit (40625)*



Twister Chem M22x1,5

Large surface cleaner w/detergent kit (40627)*



Detergent chemicals

Car (40613) 24 units
Motorbikes (40614) 24 units
Boat (40615) 24 units
Universal (40616) 24 units



16m Extension hose kit Pro

(40641)
Fitting included in kit M22x1,5(M)-1/4"(M) (1122030)*



RLW (S-SV)

Hose reel kit (40645) Without HP hose (40340) W/15m HP hose



Pipe Jet Pro 8m/16m

Pipe drain cleaning kit 8m (40109) · 16m (40110)



DRS

Underbody lance kit (40633)



Sandblast Pro

Sandblasting lance kit (40628)



Rotopower Pro

Turbo nozzle lance (40638)



Sand (5kg)

Calibrated and filtered sand (3207)



Click Fast kit (ø 3/4")

Water inlet fitting w/quick coupling kit (40439)



Suction water kit

(40822)*



Water filter kit

Inlet-outlet 3/4"G (F-M) 60 Mesh (40743) (40744)*



Industrial Multiclean Systems

912, Maradana Road, Colombo 08, Sri Lanka.
Tele: +94 11 2698373 Hotline: +94 777 27273
Fax: +94 11 2699927 Email: info@multicleansystems.com

* with packaging